

NOTE: BREAK ALL CORNERS WITH 0.015" (.38 MM) RADIUS UNLESS OTHERWISE NOTED. STANDARD TOLERANCES TO APPLY UNLESS OTHERWISE SPECIFIED.

CUSTOMER PART No.	CUSTOMER <b>CAN ART STD.</b>	DIE No. <b>EH05154</b>
DESCRIPTION <b>0.875" O.D. x 0.065" THK. ROUND TUBE</b>		PROPOSAL No. <b>H-785</b>

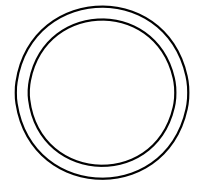
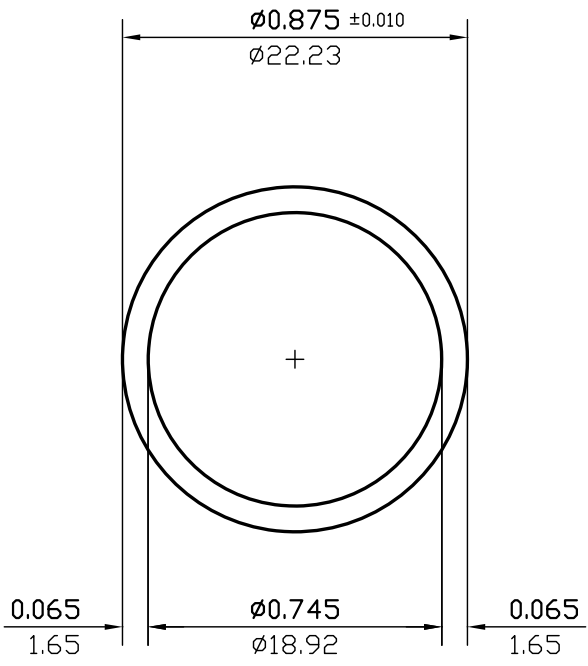

ACTUAL SIZE

DATE		REV	DESCRIPTION		BY
03/10/23		2	REMOVED EXPOSED SURFACES AND ALLOY		JASON
08/04/99		1	REDRAWN		P.M.
EST.AREA	0.165	IN. <sup>2</sup>	EST.AREA	107	MM. <sup>2</sup>
EST.WT.	0.195	LBS/FT.	EST.WT.	0.290	KG/M.
EST.PER.	5.089	IN.	EST.PER.	129.3	MM.
OUT PER.	2.749	IN.	OUT PER.	69.8	MM.
C.C.D.	0.875	IN.	C.C.D.	22	MM.
FACTOR	26	FINISH	M/F	ALLOY & TEMP.	
CKD BY	SCALE	2:1	DWN BY	G.M.	DATE 08/12/88

# CAN ART

ALUMINUM EXTRUSION INC.

85 PARKSHORE DRIVE  
BRAMPTON, ONT L6T 5M1  
TEL. NO. (905) 791-1464  
FAX NO. (905) 791-9151  
E-MAIL: canart@canart.com

THIS DRAWING IS NOT NECESSARILY A COPY OF YOUR ORIGINAL. PLEASE APPROVE DIMENSIONS AND TOLERANCES INDICATED. CAN ART ASSUMES NO RESPONSIBILITY EITHER TECHNICAL OR LEGAL FOR HAVING THIS SHAPE MADE. THE CUSTOMER AGREES TO FULLY PROTECT CAN ART ALUMINUM FROM CLAIMS OF OTHERS RESULTING FROM THIS SHAPE.

SIGNED: \_\_\_\_\_ DATE: \_\_\_\_\_